

PORTABLE SILOS - 1400 CU. FT. CAPACITY



1400 cu. ft. portable silo used for loading bulk trucks at rail yard. Shown with optional displacement baghouse and air compressor.

STANDARD FEATURES

- 60 Ton Capacity (Cement)
- Positive Feed Drive
- 10" Diameter Screw (12 cf/minute)
- 10hp 3 Phase Motor and Gear Box Drive
- 150 sq. ft. Bag House with Electric Vibrator
- Upper Level Bindicator with Light and Horn Alarm
- Starter Panel
- Cone Actuators
- Caged Ladder with Rail Package
- Heavy Duty Axle Trailer with Light Package

OPTIONS

- 225 sq. Ft. Bag House
- Non-stick Cone Coating
- 12" Diameter Screw (33 cf/minute)
- 20HP 3 Phase Motor and Gear Box Drive
- Lower Level Indicator

SETUP/SITE REQUIREMENTS

Compacted, level soil or better

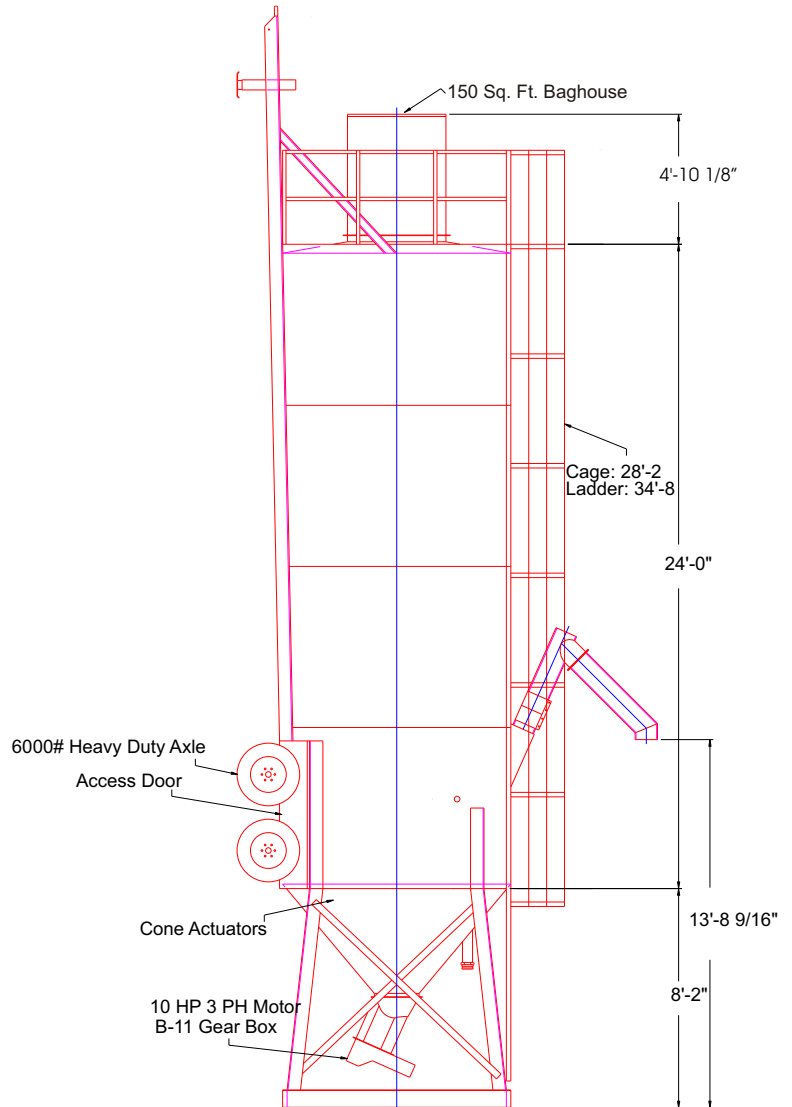

APPLICATIONS

- Cement
- Fly Ash
- Lime
- CKD
- Sand
- Bentonite/Clay
- Calcium Carbonate
- Chemical Powder Products
- Agricultural Powder Products
- Food Grade Dry Bulk Products